

Based upon the Ordnance Survey mapping with the permission of the Controller of Her Majesty's Stationery Office. © Crown copyright. Unauthorised reproduction infringes Crown copyright and may lead to prosecution or civil proceedings. 1000233002011

Key

- Existing 'Disabled' parking bay to be replaced with double yellow lines
- Proposed 'No waiting at any time' (double yellow lines)
- Existing car park

Plan for illustrative purposes only - do not scale

A	Restrictions altered after informal consultation and Steering Group	25/4/12
	Revision	



PLANNING, TRANSPORT & LEISURE

Chief Engineer
Mike McCulloch
 BSc(Eng) (Hons) C. Eng MICE
 Gibson Building
 Gibson Drive
 Kings Hill
 West Malling
 Kent ME19 4LZ
 Tel: 01732 844522 Fax: 01732 876317

Project Title
 Aylesford Parking Review
 Amended Parking Restrictions

Drawing Title
 Powell Close
 Aylesford

Drawn ACB	Checked	Date 12/12/11	
Scale 1:500 @ A4			
Drawing No. DD/559/4		Rev A	

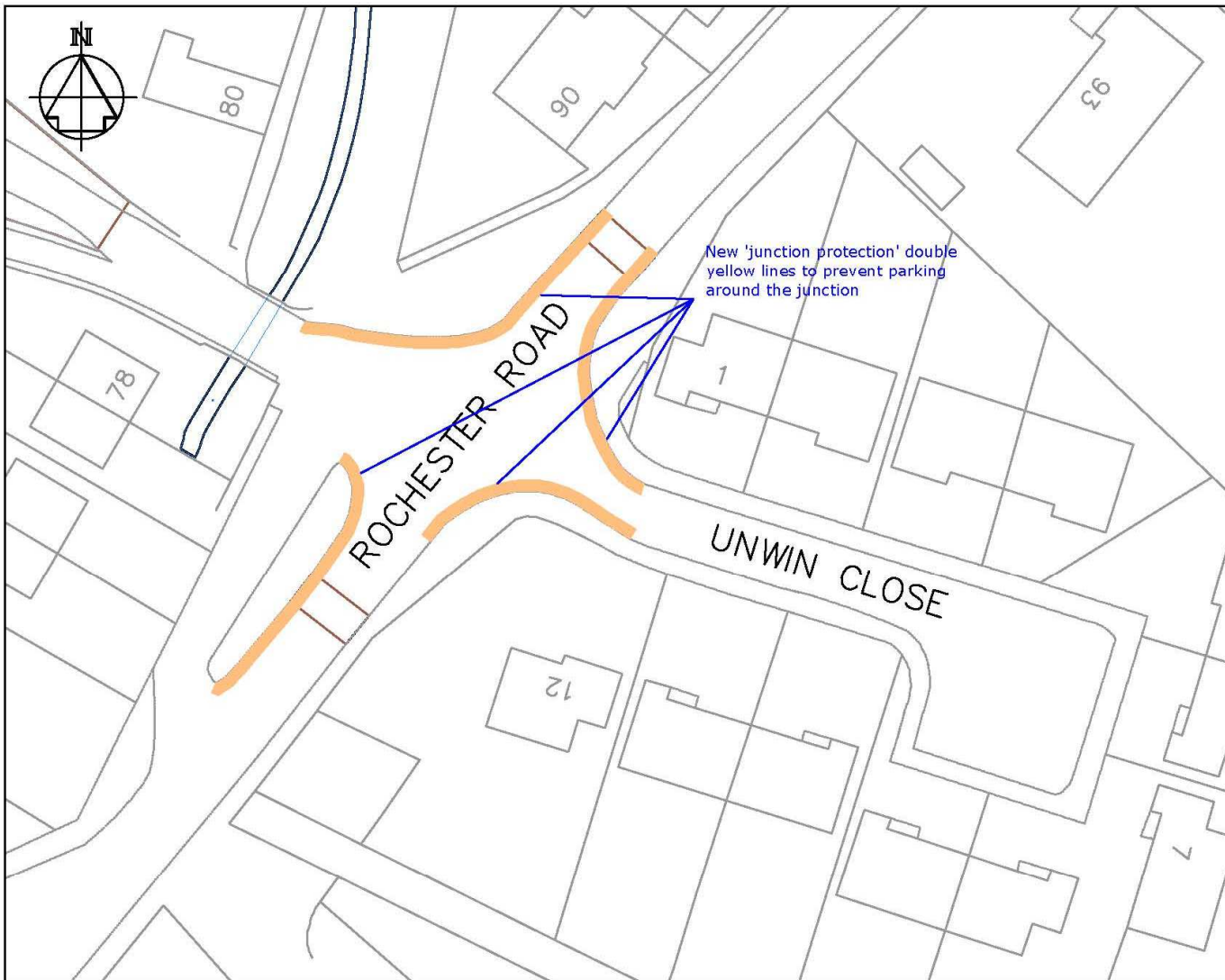
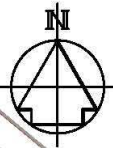

New 'junction protection' double yellow lines to prevent parking around the junction

Based upon the Ordnance Survey mapping with the permission of the Controller of Her Majesty's Stationery Office. © Crown copyright. Unauthorised reproduction infringes Crown copyright and may lead to prosecution or civil proceedings. 1000233002011

Key

— Proposed 'No waiting at any time' (double yellow lines)

Plan for illustrative purposes only - do not scale

A		
	Revision	



PLANNING, TRANSPORT & LEISURE

Chief Engineer
Mike McCulloch
 BSc(Eng) (Hons) C. Eng MICE
 Gibson Building
 Gibson Drive
 Kings Hill
 West Malling
 Kent ME19 4LZ
 Tel: 01732 844522 Fax: 01732 876317

Project Title
Aylesford Parking Review
Amended Parking Restrictions

Drawing Title
Unwin Close
Aylesford

Drawn ACB	Checked	Date 12/12/11
Scale 1:500 @ A4		
Drawing No. DD/559/3	Rev -	

Based upon the Ordnance Survey mapping with the permission of the Controller of Her Majesty's Stationery Office. © Crown copyright. Unauthorised reproduction infringes Crown copyright and may lead to prosecution or civil proceedings. 1000233002011

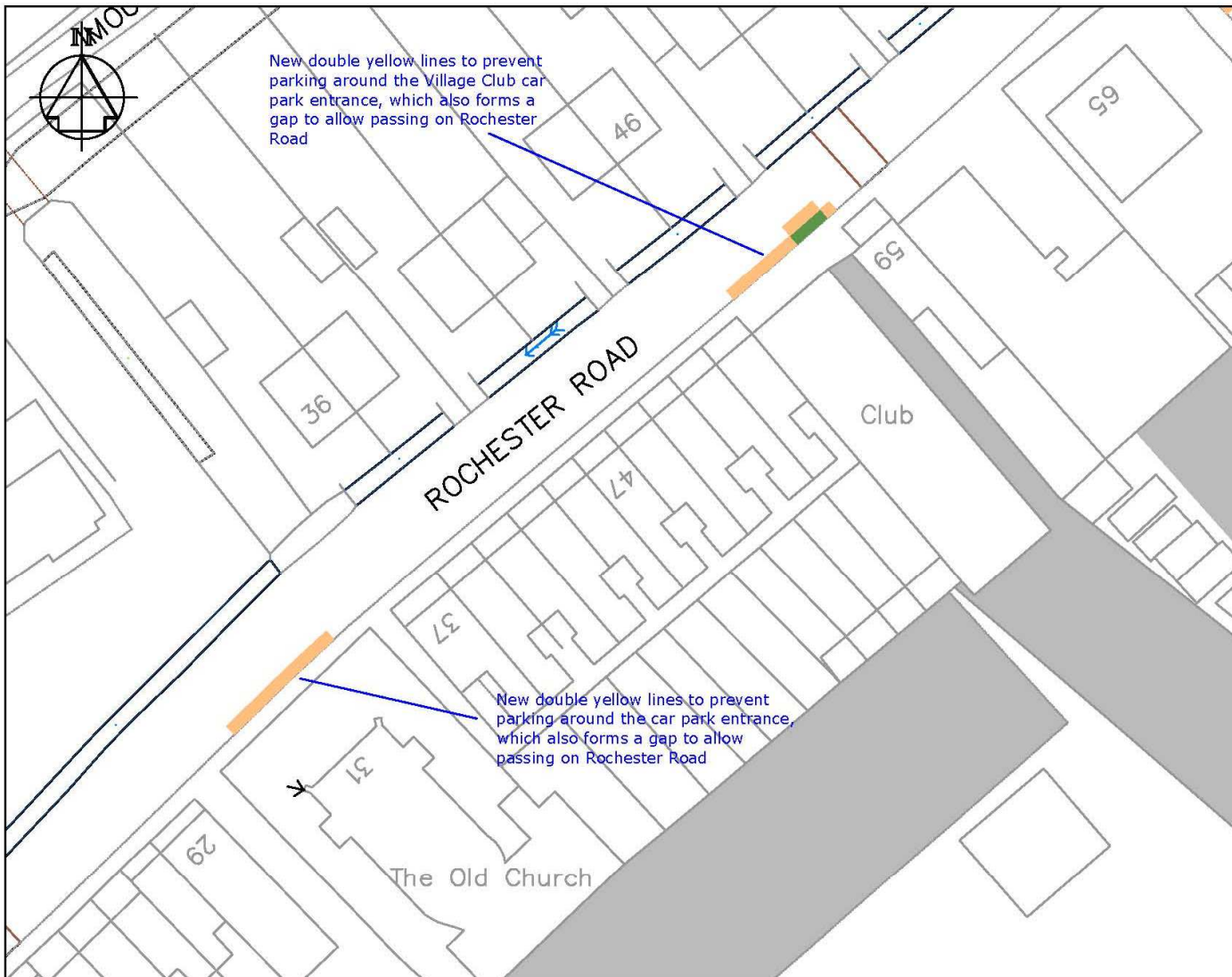

Key

- Proposed 'No waiting at any time' (double yellow lines)
- Existing 'Access protection marking'
- Existing car park

Plan for illustrative purposes only - do not scale

A		
	Revision	



PLANNING, TRANSPORT & LEISURE

Chief Engineer
Mike McCulloch
 BSc(Eng) (Hons) C Eng MICE
 Gibson Building
 Gibson Drive
 Kings Hill
 West Malling
 Kent ME19 4LZ
 Tel: 01732 844522 Fax: 01732 876317

Project Title
 Aylesford Parking Review
 Amended Parking Restrictions

Drawing Title
 Rochester Road
 Aylesford

Drawn ACB	Checked	Date 12/12/11
Scale		1:500 @ A4
Drawing No. DD/559/5		Rev -

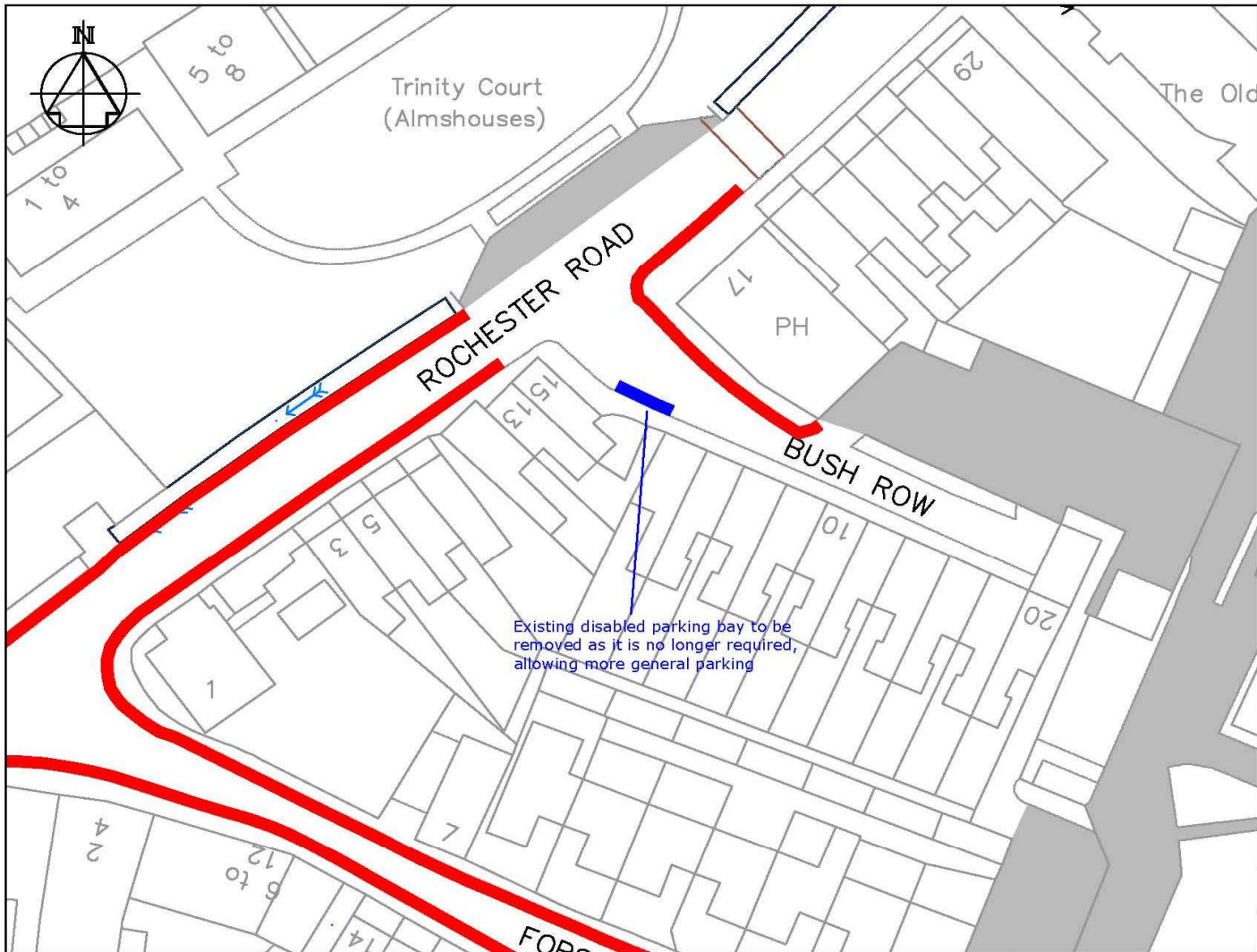

Based upon the Ordnance Survey mapping with the permission of the Controller of Her Majesty's Stationery Office. © Crown copyright. Unauthorised reproduction infringes Crown copyright and may lead to prosecution or civil proceedings. 1000233002011

- Key**
- Existing 'No waiting at any time' (double yellow lines)
 - Redundant 'Disabled' parking place to be removed
 - Existing vehicle access

Plan for illustrative purposes only - do not scale

A	Proposal altered following consultation and Steering Group	25/4/12
	Revision	



PLANNING, TRANSPORT & LEISURE

Chief Engineer
Mike McCulloch
 BSc(Eng) (Hons) C Eng MICE
 Gibson Building
 Gibson Drive
 Kings Hill
 West Malling
 Kent ME19 4LZ
 Tel: 01732 844522 Fax: 01732 876317

Project Title
 Aylesford Parking Review
 Amended Parking Restrictions

Drawing Title
 Bush Row
 Aylesford

Drawn ACB	Checked	Date 12/12/11	
Scale		1:500 @ A4	
Drawing No. DD/559/7			Rev A

Based upon the Ordnance Survey mapping with the permission of the Controller of Her Majesty's Stationery Office. © Crown copyright. Unauthorised reproduction infringes Crown copyright and may lead to prosecution or civil proceedings. 1000233002011

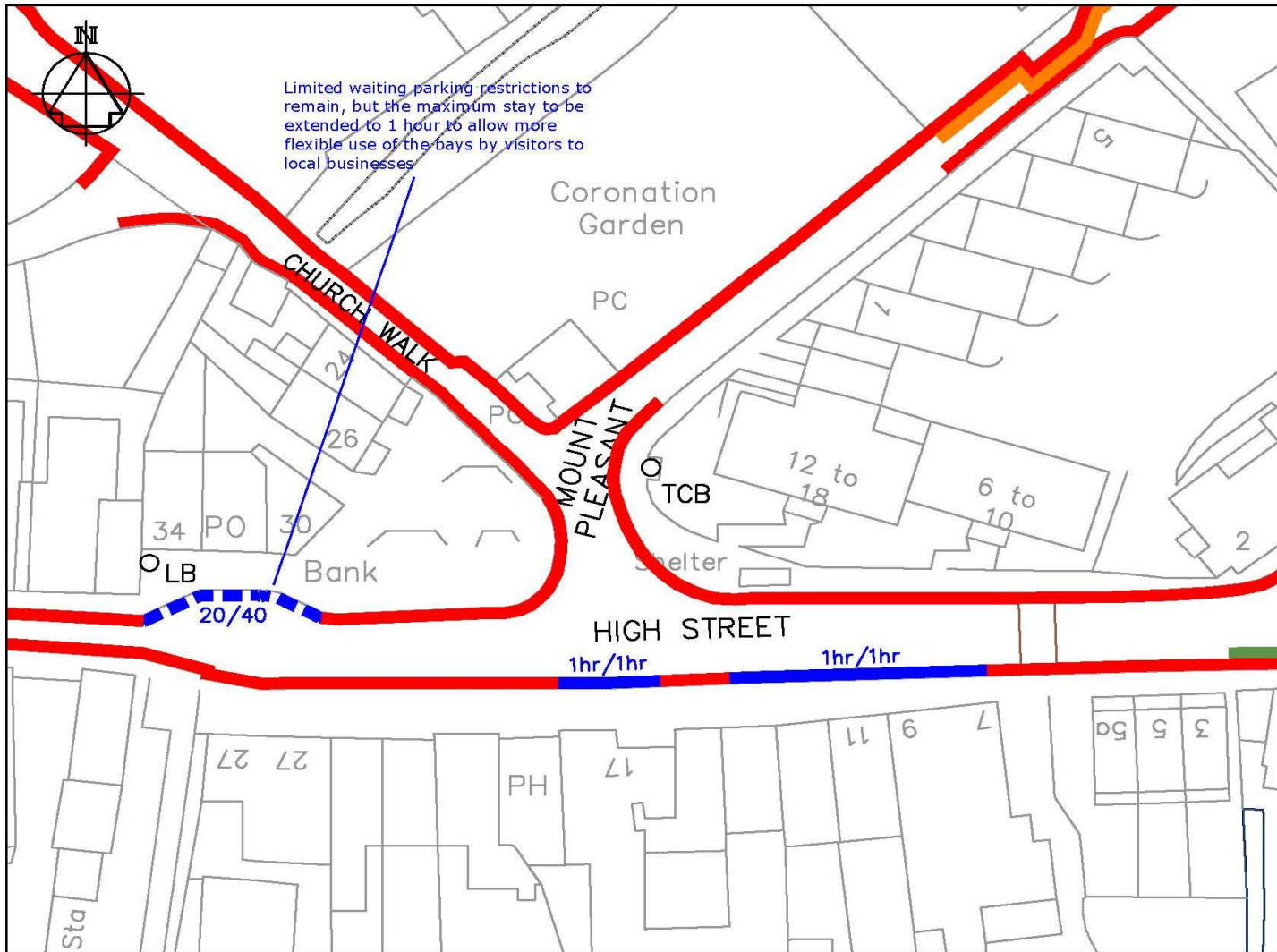

Key

- Existing 'No waiting at any time' (double yellow lines)
- - - Existing 20minute Limited waiting (to change to either 1hr/1hr)
- Existing 1hour Limited waiting (to be retained)
- - - Existing 'School Keep Clear' Mon-Fri, 8.30am - 3.30pm (yellow zig-zags)
- Existing 'Access protection line'

Plan for illustrative purposes only - do not scale

A	Times altered following informal consultation and Steering Group	25/4/12
	Revision	



Chief Engineer
Mike McCulloch
 BSc(Eng) (Hons) C Eng MICE
 Gibson Building
 Gibson Drive
 Kings Hill
 West Malling
 Kent ME19 4LZ
 Tel: 01732 844522 Fax: 01732 876317

Project Title
 Aylesford Parking Review
 Amended Parking Restrictions

Drawing Title
 High Street
 Aylesford

Drawn ACB	Checked	Date 12/12/11
Scale 1:500 @ A4		
Drawing No. DD/559/6		Rev A

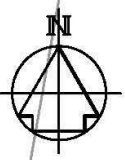



St Peter's Church

Existing single yellow lines to be removed to allow more parking

Based upon the Ordnance Survey mapping with the permission of the Controller of Her Majesty's Stationery Office. © Crown copyright. Unauthorised reproduction infringes Crown copyright and may lead to prosecution or civil proceedings. 1000233002011

Key

-  Existing 'No waiting at any time' (double yellow lines)
-  Existing 'No waiting, Mon - Sat 8am-6pm' (single yellow line)
-  Proposed 'No waiting, Mon - Sat 8am-6pm' to be revoked

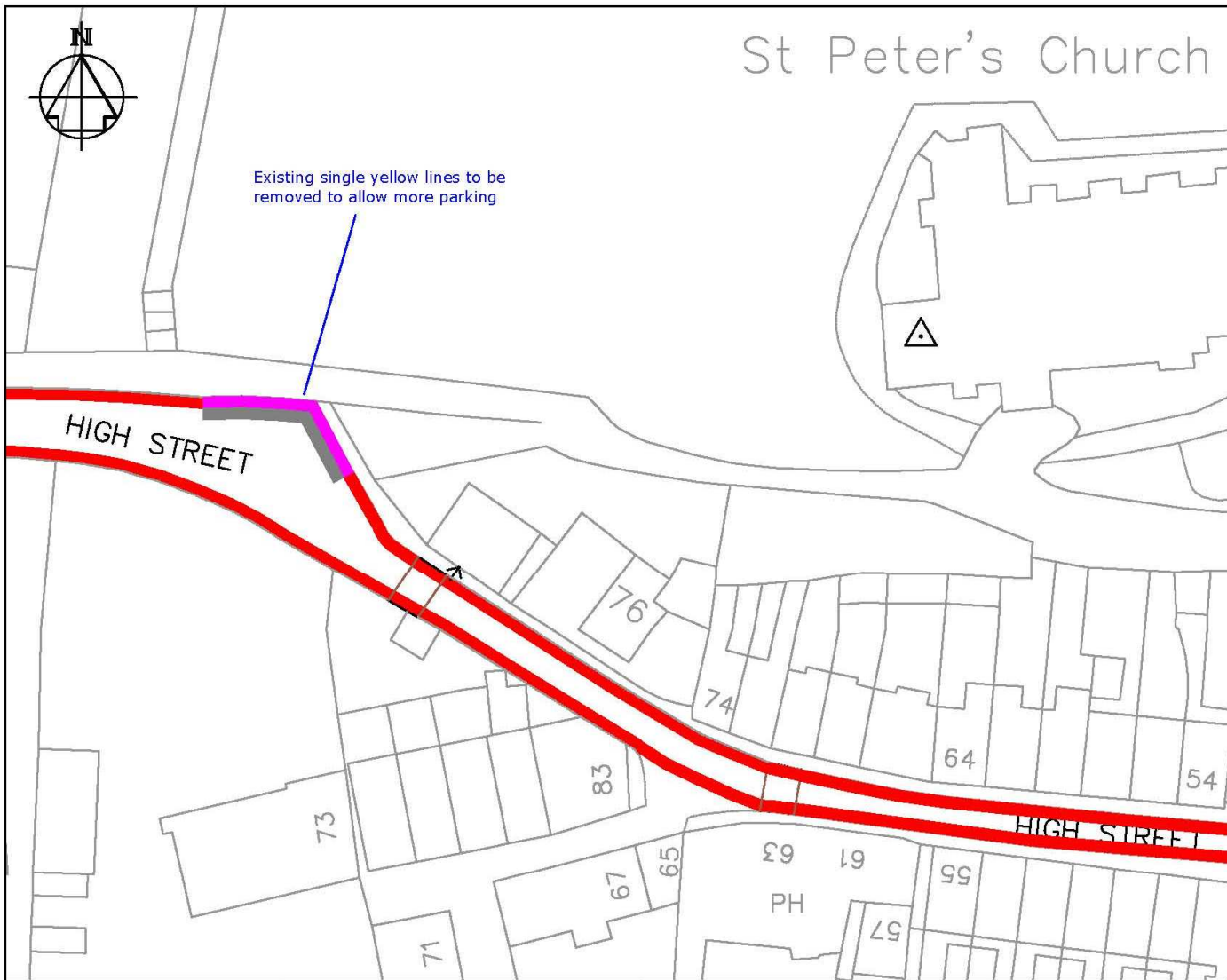

Plan for illustrative purposes only - do not scale

A		
	Revision	



PLANNING, TRANSPORT & LEISURE

Chief Engineer
Mike McCulloch
 BSc(Eng) (Hons) C Eng MICE
 Gibson Building
 Gibson Drive
 Kings Hill
 West Malling
 Kent ME19 4LZ
 Tel: 01732 844522 Fax: 01732 876317

Project Title
 Aylesford Parking Review
 Amended Parking Restrictions

Drawing Title
 High Street (West)
 Aylesford

Drawn ACB	Checked	Date 12/12/11
Scale 1:500 @ A4		
Drawing No. DD/559/8		Rev -

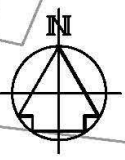

Based upon the Ordnance Survey mapping with the permission of the Controller of Her Majesty's Stationery Office. © Crown copyright. Unauthorised reproduction infringes Crown copyright and may lead to prosecution or civil proceedings. 1000233002011

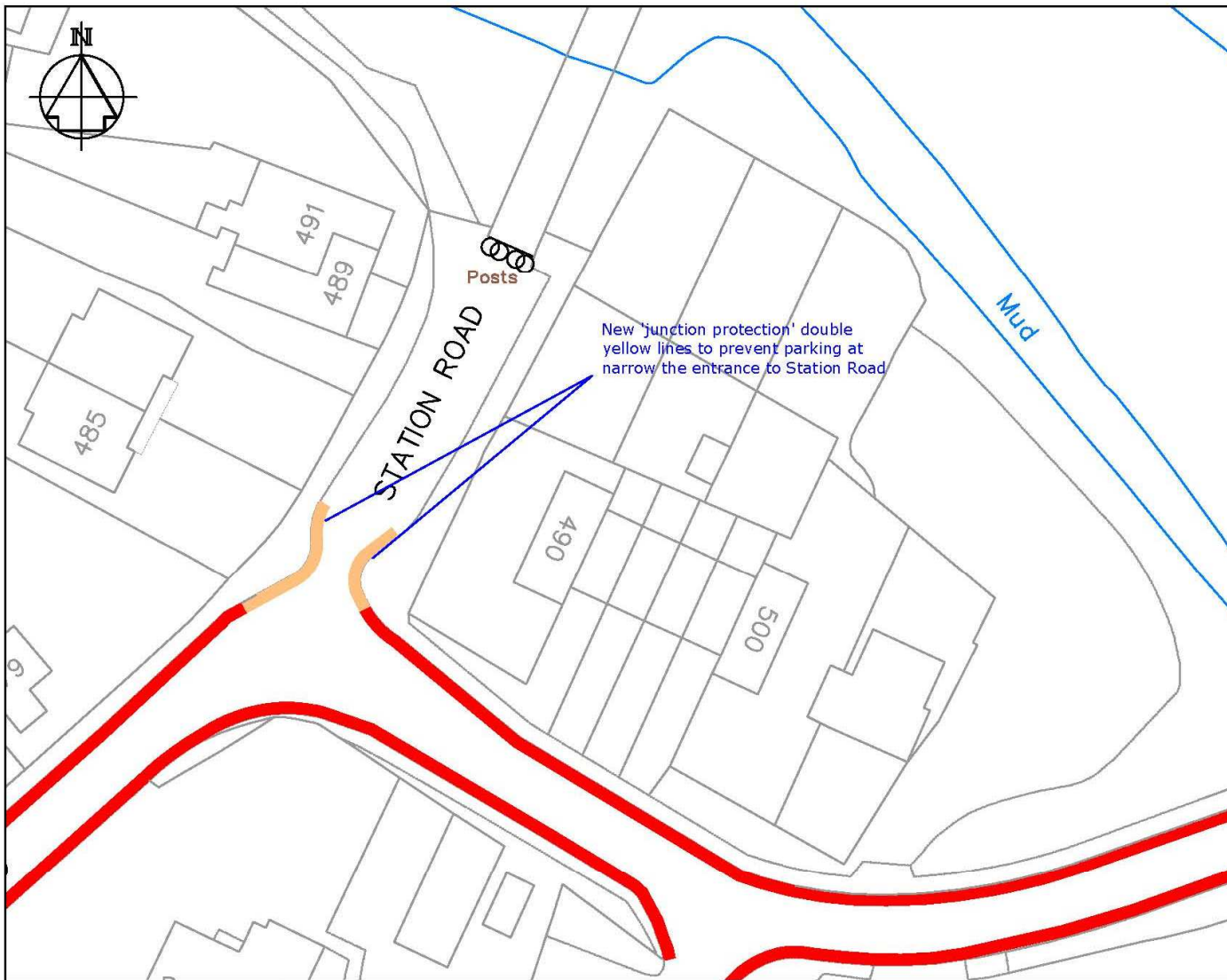

- Key**
- Existing 'No waiting at any time' (double yellow lines)
 - Proposed 'No waiting at any time' (double yellow lines)

Plan for illustrative purposes only - do not scale

A		
	Revision	



PLANNING, TRANSPORT & LEISURE

Chief Engineer
Mike McCulloch
 BSc(Eng) (Hons) C Eng MICE
 Gibson Building
 Gibson Drive
 Kings Hill
 West Malling
 Kent ME19 4LZ
 Tel: 01732 844522 Fax: 01732 876317

Project Title
 Aylesford Parking Review
 Amended Parking Restrictions

Drawing Title
 Station Road
 Aylesford

Drawn ACB	Checked	Date 12/12/11
Scale		1:500 @ A4
Drawing No. DD/559/2		Rev -

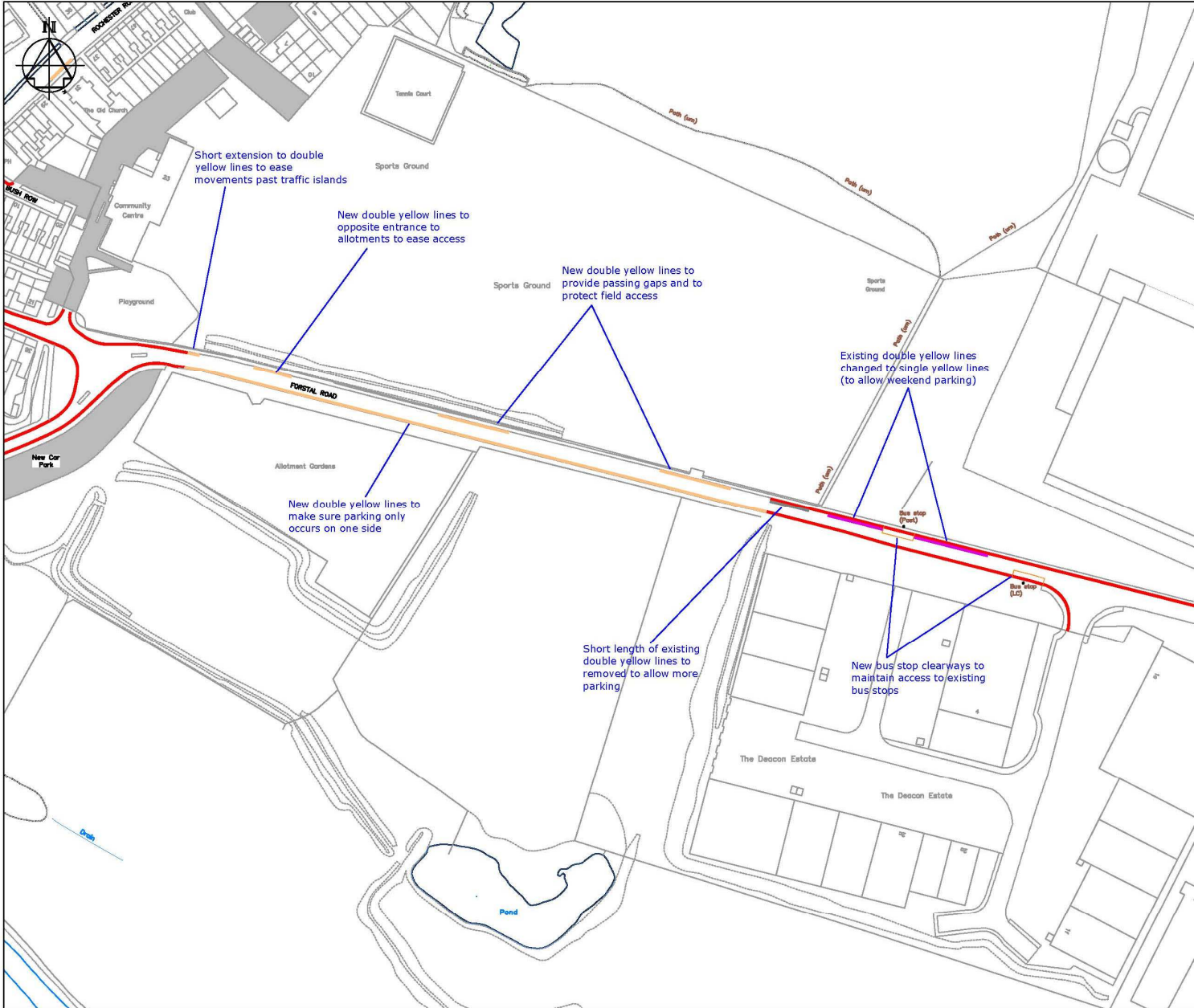

Based upon the Ordnance Survey mapping with the permission of the Controller of Her Majesty's Stationery Office. Crown copyright. Unauthorised reproduction infringes Crown copyright and may lead to prosecution or civil proceedings. 100023902011

Key

- Existing 'No waiting at any time' (double yellow lines)
- Proposed 'No waiting at any time' (double yellow lines)
- Proposed 'No waiting, Mon-Fri, 8am-6pm (single yellow lines)
- Proposed 'Bus stop clearway'
- Proposed double yellow line restrictions to be removed

Plan for illustrative purposes only - do not scale

A	Restrictions altered after informal consultation and Steering Group	25/4/12
	Revision	Date



TONBRIDGE & MALLING
BOROUGH COUNCIL

PLANNING, TRANSPORT & LEISURE

Chief Engineer
Mike McCulloch
 BSc(Eng) (Hons) C Eng MICE
 Gibson Building
 Gibson Drive
 Kings Hill
 West Malling
 Kent ME19 4LZ
 Tel: 01732 844522 Fax: 01732 876317

Project Title
 Aylesford Parking Review
 Amended Parking Restrictions

Drawing Title
 Forstal Road
 Aylesford

Drawn ACB	Checked	Date 12/12/11
Scale 1:1500 @ A3		

Drawing No. DD/559/1	Rev A
-------------------------	----------